

REVISIONS		
NO.	DESCRIPTION	DATE

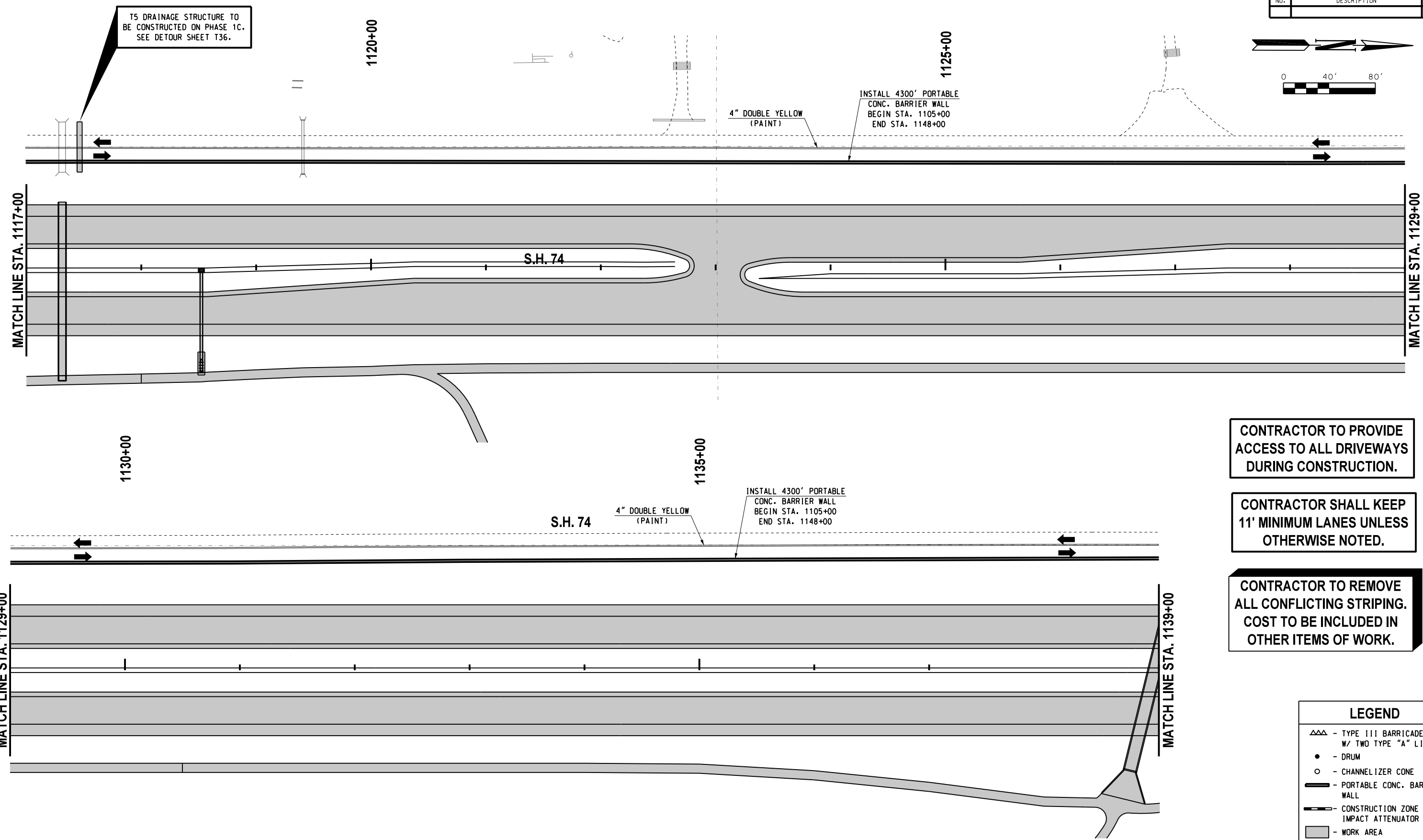
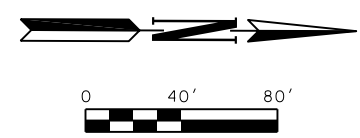

CONTRACTOR TO PROVIDE ACCESS TO ALL DRIVEWAYS DURING CONSTRUCTION.

CONTRACTOR SHALL KEEP 11' MINIMUM LANES UNLESS OTHERWISE NOTED.

CONTRACTOR TO REMOVE ALL CONFLICTING STRIPING. COST TO BE INCLUDED IN OTHER ITEMS OF WORK.

LEGEND	
	- TYPE III BARRICADE W/ TWO TYPE "A" LIGHTS
	- DRUM
	- CHANNELIZER CONE
	- PORTABLE CONC. BARRIER WALL
	- CONSTRUCTION ZONE IMPACT ATTENUATOR
	- WORK AREA

Design	GDB	08/10/17
Drawn	RWR	08/10/17
<b>TEC</b> A CLEAR DIRECTION		

**TRAFFIC CONTROL**  
**PHASES 1G & H (SHEET 2 OF 3)**  
**S.H. 74 (STA. 1117+00 TO 1139+00)**  
 State Job No. 14964(08) Sheet No. 140

08/10/17 G:\Projects\1-6628 SH 74 @ NW 178th, NW 192nd & NW 206th\CAD\TC PHASE 1G.H.2 SH 74.dgn